

Catalog #		Date		Prepared by	
Project		Type		Notes	

**HALO™**  
OUTDOOR LIGHTING

**SOLAR  
POWERED | LED**

## SLST SOLAR AREA FLOODLIGHT

WITH ALL-IN-ONE DESIGN AND 3 MODES OF OPERATION



Halo Outdoor all-in-one integrated solar floodlight adds safety and security to your home, property, or business with its ultra bright, long-lasting, all-weather lighting. It comes with an efficient solar panel for a seamless experience. Choose from 4 lumen packages and mount up to 15ft. With 3 selectable modes and integrated dusk-to-dawn functionality, it's perfect for rural and off-grid areas. Easy to install with a 1-year warranty.

### TOP PRODUCT FEATURES

Super bright up to  
**4500 LUMENS**

MODES OF OPERATION / MODES DE FONCTIONNEMENT

MOTION ACTIVATED  
MOUVEMENT ACTIVE

DUSK to DAWN  
DU CRÉPUSCULE à L'AUBE

DUSK to DAWN + MOTION ACTIVATED  
DU CRÉPUSCULE à L'AUBE + MOUVEMENT ACTIVE

5000K  
BRIGHT WHITE

50,000 HR  
LED LIFESPAN

IP65  
WEATHER RESISTANT

RECHARGEABLE BATTERY WITH 1.5 HOUR RUN TIME

ADJUSTABLE TIME SETTINGS  
30S 60S 90S

TILTABLE BODY  
90° 30°

DETECTION AREA  
120°

DETECTION DISTANCE  
20'

MOUNTING HEIGHT  
15'

REMOTE CONTROL

1 YEAR LIMITED WARRANTY

15G VIB



### INTERACTIVE MENU

- [Order Information](#) page 5
- [Product Specification](#) page 6
- [Product Warranty](#) page 6
- [Product Dimensions](#) page 5
- [Photometric Data](#) page 6

### PRODUCT CERTIFICATION



- Durable weather resistant polycarbonate construction with IP65 rating
- Rechargeable Li-Ion battery pack included
- Three operation modes: Motion Mode, Dusk-to-dawn mode, Motion + Dusk-to-dawn mode
- Top mounted solar panel ensures light is easily adjustable up and down for optimum positioning for direct sunlight
- High-efficiency solar panel, waterproof and dustproof construction, and high-impact ABS polycarbonate lens for ultra durability
- Motion sensor with 120-degree detection zone and 20-ft detection distance
- Adjustable LED panels enable user to direct light further outward if preferred
- Wall and pole mount accessories included
- IP65 Rated- Perfect for outdoor applications
- Available in textured bronze finish
- 1-year warranty

### TYPICAL APPLICATIONS



### COMMERCIAL & RESIDENTIAL OUTDOOR

- Garages
- Carports
- Driveways
- Loading Bays
- Warehouses
- Apartment Complexes
- Hotels
- Offices
- General Security Lighting

Or anywhere where trenching wire is cost prohibited.  
Put light anywhere simply and easily with Solar Power!

### MOUNTING LOCATION BEST PRACTICES

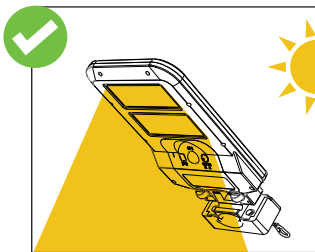

Most hours of direct sunlight,  
unblocked by trees or buildings

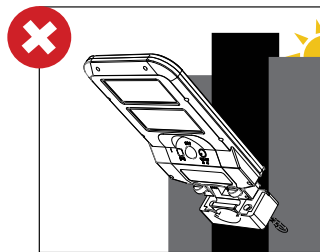

Limited or no direct sunlight,  
shaded or blocked by trees or  
buildings

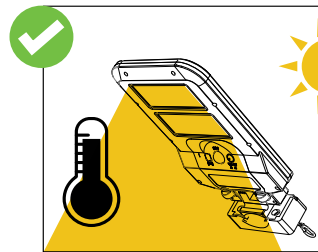

Warmer location with  
predominant sunshine  
= Maximum performance

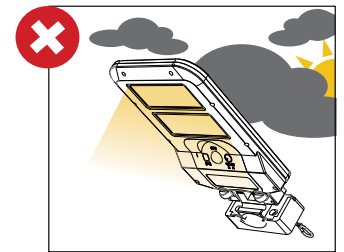

Cold location with consecutive  
cloud covered days = Possible  
inconsistent performance

### PRODUCT FEATURE HIGHLIGHTS

#### ALL IN 1 DESIGN WITH REMOTE CONTROL



#### MULTIPLE WAYS TO MOUNT

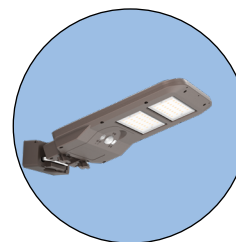

#### WALL MOUNT

Mount light  
fixture to wall  
using included  
lag screws



#### POLE MOUNT

Pole Mount (pole  
sold separately)  
by using included  
hardware

### PRODUCT FEATURE HIGHLIGHTS (CONTINUATION)

#### INTEGRATED MOTION SENSOR

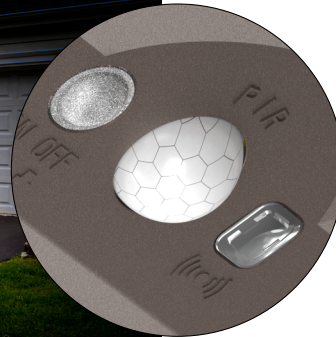
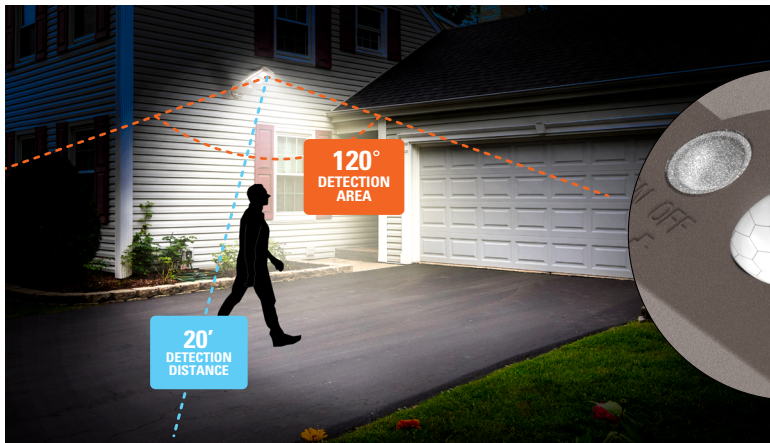

Fixture can be mounted 15' high and motion sensor has a detection angle (range) of 120 Degrees and can detect people up to 20' away.

#### REMOTE CONTROL SETTINGS

#### Modes of operation

- Motion: Light flashes 1X
- Dusk to Dawn : Light flashes 2X
- Motion + Dusk to Dawn : Light flashes 3X

Manual ON

ON

Manual OFF

OFF

MOTION

30S

DTD

60S

MOTION & DTD

90S

Motion Mode auto time out settings

HALO™

2 x AAA BATTERIES INCLUDED

### MODES OF OPERATION



After sun down,  
fixture turns on



At sunrise, fixture turns off



#### DUSK to DAWN MODE

RUN  
TIME  
12 HRS



Fixture on @ 12% all  
night



Fixture off during the  
day



#### MOTION ACTIVATED MODE

RUN  
TIME  
1.5 HRS

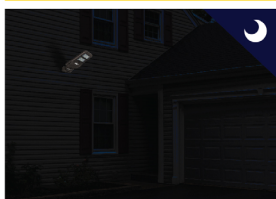

No Motion: Fixture off



With Motion:  
Fixture on @ max lumen

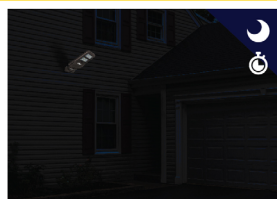

After time out:  
Fixture turns off



#### DUSK to DAWN + MOTION ACTIVATED MODE

D2D

RUN  
TIME  
11.5 HRS

MOTION

RUN  
TIME  
0.5 HRS



At night fixture turns on @ 8%  
brightness



When motion is detected fixture increases to  
30% brightness



Fixture dims down to 8% brightness after  
time out

Catalog Number	Initial Lumen Output	Operation Mode	Lumens in Motion Mode	Lumens in D2D Mode	Initial Lumen	Final Lumen	Runtime
SLST105MB	1000LM	Motion	1000	NA	1000	500	90 Min
		Motion + D2D	300 (30 Min)	80	80	0	11 Hrs 30 Min
		D2D	NA	120	120	0	12 hrs
SLST155MB	1500LM	Motion	1500	NA	1500	750	90 Min
		Motion + D2D	450 (30 Mins)	120	120	0	11 Hrs 30 Min
		D2D	NA	180	180	0	12 hrs
SLST305MB	3000LM	Motion	3000	NA	3000	1500	90 Min
		Motion + D2D	900 (30 Mins)	240	240	0	11 Hrs 30 Min
		D2D	NA	360	360	0	12 hrs
SLST455MB	4500LM	Motion	4500	NA	4500	2250	90 Min
		Motion + D2D	1350	360	360	0	11 Hrs 30 Min
		D2D	NA	540	540	0	12 hrs



### ORDER INFORMATION

Catalog Number	Description	Material No.	UPC	Case Qty	Case Dimensions (in.)			Weight (lbs)
					L	W	H	
SLST105MB	SOLAR STRT LIGHT,1000LM,5000K,MTN+D2D,BR	13631761	080083273386	4	15.35	8.27	2.56	3.53
SLST155MB	SOLAR STRT LIGHT,1500LM,5000K,MTN+D2D,BR	13631762	080083274109	4	15.35	8.27	2.56	3.53
SLST305MB	SOLAR STRT LIGHT,3000LM,5000K,MTN+D2D,BR	13631763	080083274123	4	20.87	8.27	2.56	5.26
SLST455MB	SOLAR STRT LIGHT,4500LM,5000K,MTN+D2D,BR	13631764	080083274147	4	20.87	8.27	2.56	5.26

### PRODUCT DIMENSIONS

SLST105MB  
SLST155MB

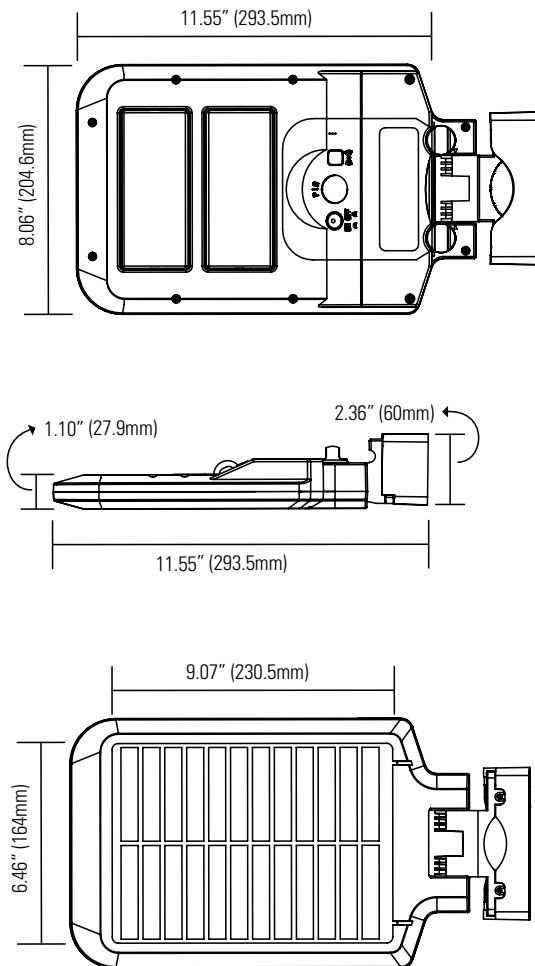

SLST305MB  
SLST455MB

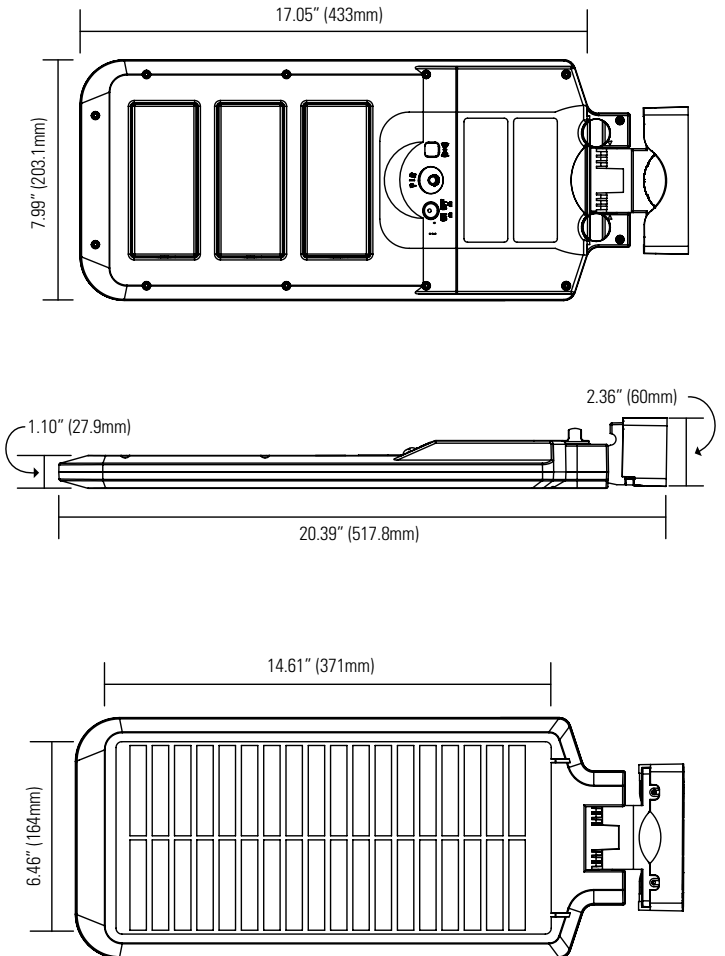

### PRODUCT SPECIFICATIONS

#### Construction

- Durable polycarbonate housing suitable for wet locations
- All-in-one design that includes fixture housing, solar panel, battery, and LED light source
- UV stable polycarbonate housing
- LED indicator light provides battery charging & discharging status

#### Optics

- Produces rated lumens when fully charged
- 5000K CCT perfect for security applications
- Clear lens for maximum light output

#### Controls

- 3 different operating modes configurable with included RF Remote control and also including standard On/Off functionality.
  - Motion Mode
  - Dusk to Dawn Mode
  - Motion + Dusk to Dawn Mode
- Auto Time Out settings of 30S, 60S & 90S when using motion mode before light turns off
- Dimming levels determined by selected mode of operation.
- Remote Control Range: 20ft-25ft (unobstructed)

#### Motion Sensor

- Passive Infrared motion sensor with a 120° detection range.
- Maximum detection distance of 20'.

#### Mounting

- Wall mount using included (2) lag screws and washers.
- Pole mount to any standard 2" curved pole (sold separately) with included U-bolt
- Mounting hardware included in packaging.

#### Electrical

- 120° Motion sensor with detection range up to 20 feet.
- Integrated rechargeable Li-Ion battery pack
- 90-minute continuous runtime on a full charge in motion mode
- Maintenance - free LEDs with estimated 50,000 hours lifespan based on LM-80 results and TM-21 calculations.
- Rated for ambient operating temperature range from 32°F (0°C) to 104°F (40°C)
- Integral photocell allows for nighttime ON / daytime OFF operation

#### Compliance

- IP65 Rated- Perfect for demanding outdoor applications.
- Contains no mercury or lead - RoHS compliant (RoHS 2.0)
- Photometric testing in accordance with IES LM-79-08
- Lumen maintenance projections in accordance with IES LM-80-08 and TM-21-11.
- UN38.3 transportation certified

#### Battery

- Total battery capacity of 90 minutes if run continuously at full brightness.
- Battery recharge time of 8 hours in full direct sunlight
- Batteries are not removable or replaceable.

#### Finish

Textured Bronze Finish

#### Warranty

- One year limited warranty, consult website for details. [www.cooperlighting.com](http://www.cooperlighting.com)

### OPTIONAL ACCESSORIES (SOLD SEPARATELY)



**SBL-RC**  
Solar Barn Light,  
Remote Control



**EA24**  
24in Mounting  
Arm for Area  
Lights

### PHOTOMETRIC DATA

Series	Battery capacity (WH)	Delivered Lumens (lm)	CCT (K)	CRI
SLST105MB	16.28	1000	5000K	70
SLST155MB	16.28	1500	5000K	70
SLST305MB	32.56	3000	5000K	70
SLST455MB	48.84	4500	5000K	70

### SUGGESTED MOUNTING HEIGHT

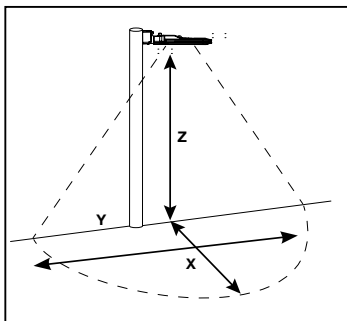

Minimum Footcandles (FC)		0.50 FC							
Mounting Height (Z)		8'		10'		15'		20'	
Catalog Number	Lumens	X	Y	X	Y	X	Y	X	Y
SLST105MB	1118	12	24	13	26	14	29	/	/
SLST155MB	1547	12	27	14	30	16	33	/	/
SLST305MB	2953	16	33	17	36	21	42	/	/
SLST455MB	4293	17	35	20	41	24	48	26	52

X = Forward Throw  
Y = Wall Spread  
Z = Mounting Heights

Notes:  
Forward throw X = 1/2 Y for wall-mount applications only  
See IES files for detailed photometry